

MOUNTING AND OVERALL DIMENSIONS

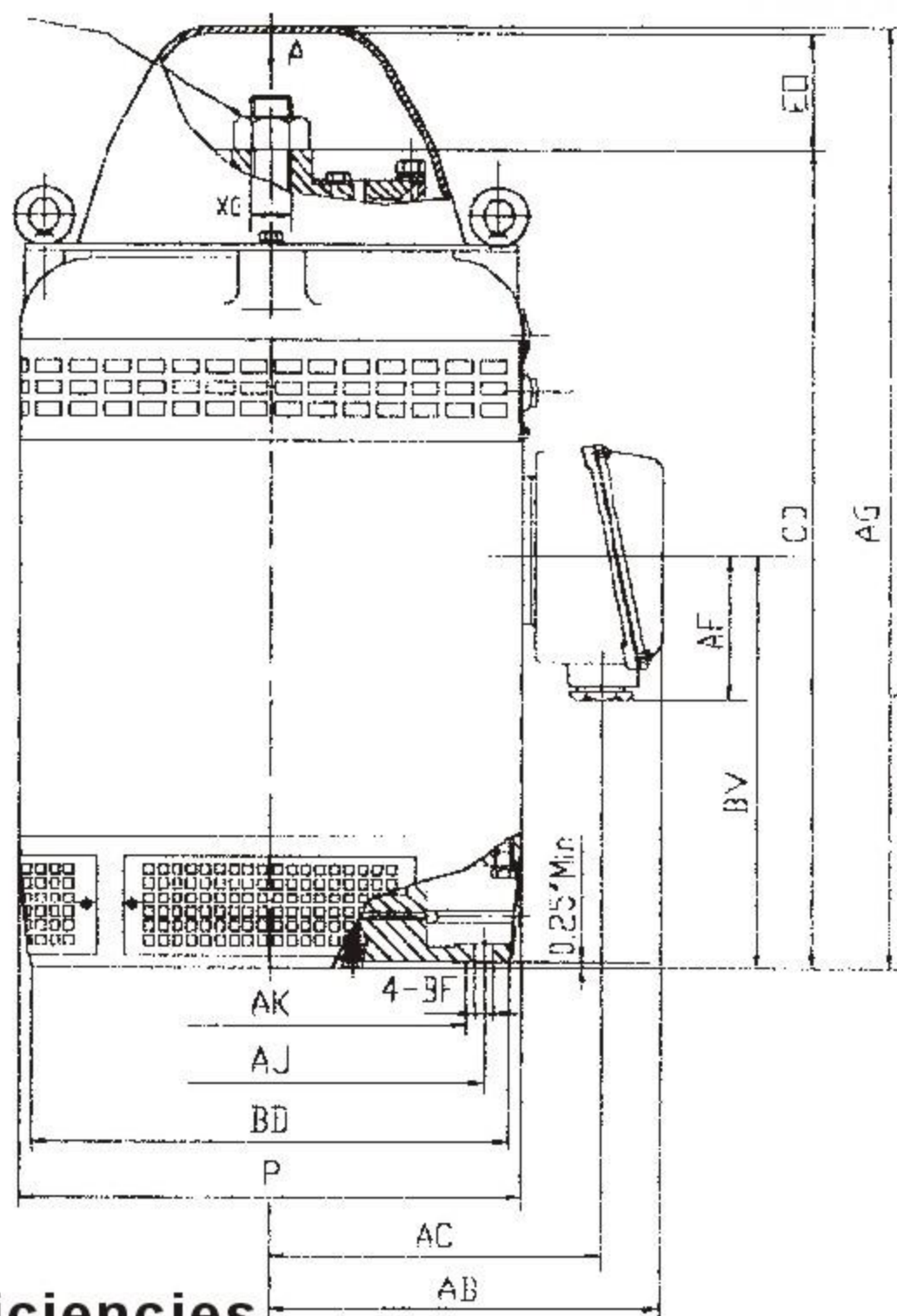
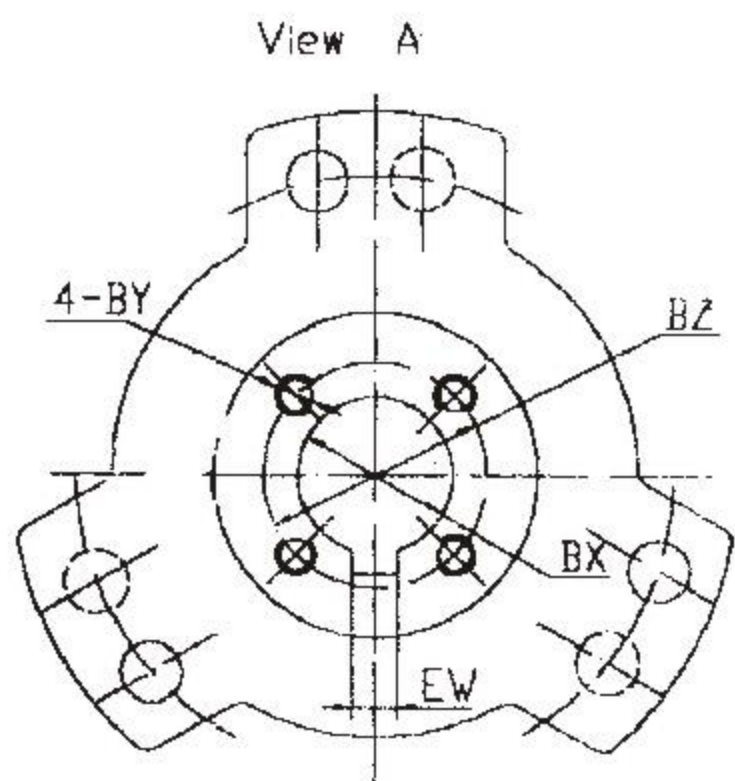

WPI for 184TP-5008P Dimensions for all efficiencies

| Model No. | Frame | Mounting Dimensions(inch) | | | | | | | | | | | Overall Dimensions(inch) | | | Bearings | | Weight (L/B) | | |
|-----------|----------|---------------------------|-----------------|------|-------|------|-------|-------------------|-------|-------|---------|-------|--------------------------|------|-------|----------|-------|--------------|-----------|--------------------|
| | | BD | AJ | AK | BV | AF | BF | BX | BZ | EW | BV | CD | EO | P | AB | AC | AG | | Drive End | Opposite Drive End |
| 5HP | 184 TP | 10 | 9 $\frac{1}{8}$ | 8.25 | 8 | 2.85 | 0.44 | 0.75 | 1.375 | 0.25 | 8 | 17.56 | 3.21 | 12.9 | 7.56 | 6.5 | 21.25 | 6208Z | 7309B | 260 |
| 7.5HP | 213 TP | 10 | 9 $\frac{1}{8}$ | 8.25 | 8 | 3.31 | 0.44 | 0.75 | 1.375 | 0.25 | 8 | 17.56 | 3.21 | 12.9 | 7.56 | 6.5 | 21.25 | 6208Z | 7309B | 300 |
| 10HP | 215 TP | 10 | 9 $\frac{1}{8}$ | 8.25 | 8 | 3.25 | 0.44 | 1 | 1.375 | 0.19 | 10-32 | 17.56 | 3.34 | 12.9 | 7.56 | 6.5 | 21.25 | 6210 | 7310B | 325 |
| 15HP | 254 TP | 10 | 9 $\frac{1}{8}$ | 8.25 | 11.5 | 3.59 | 0.44 | 1 | 1.375 | 0.25 | 10-32 | 23.38 | 3.22 | 14 | 8.94 | 7.75 | 26.75 | 6212 | 7312B | 536 |
| 20HP | 256 TP | 10 | 9 $\frac{1}{8}$ | 8.25 | 11.5 | 3.59 | 0.44 | 1 | 1.375 | 0.25 | 10-32 | 23.38 | 3.22 | 14 | 8.94 | 7.75 | 26.75 | 6212 | 7312B | 545 |
| 25HP | 284 TP | 10 | 9 $\frac{1}{8}$ | 8.25 | 12.25 | 4.44 | 0.44 | 1 | 1.375 | 0.25 | 10-32 | 24.75 | 3.22 | 14 | 9.19 | 7.75 | 28.13 | 6212 | 7312B | 560 |
| 30HP | 286 TP | 10 | 9 $\frac{1}{8}$ | 8.25 | 12.25 | 4.44 | 0.44 | 1 | 1.375 | 0.25 | 10-32 | 24.75 | 3.22 | 14 | 9.19 | 7.75 | 28.13 | 6212 | 7312B | 580 |
| 40HP | 324 TP | 16.5 | 14.75 | 13.5 | 11.1 | 4 | 0.69 | 1 $\frac{1}{4}$ | 1.75 | 0.25 | 0.25-20 | 28.22 | 4.22 | 17.5 | 14.75 | 11.19 | 33 | 7221B | 6213-ZZ | 832 |
| 50HP | 326 TP | 16.5 | 14.75 | 13.5 | 11.1 | 4 | 0.69 | 1 $\frac{1}{4}$ | 1.75 | 0.25 | 0.25-20 | 28.22 | 4.22 | 17.5 | 14.75 | 11.19 | 33 | 7221B | 6213-ZZ | 880 |
| 60HP | 364 TP | 16.5 | 14.75 | 13.5 | 14 | 4 | 0.69 | 1 $\frac{1}{4}$ | 1.75 | 0.25 | 0.25-20 | 31.16 | 4.56 | 19.1 | 15.55 | 11.19 | 36 | 7224B | 6214-ZZ | 1100 |
| 75HP | 365 TP | 16.5 | 14.75 | 13.5 | 14 | 4 | 0.69 | 1 $\frac{1}{4}$ | 1.75 | 0.25 | 0.25-20 | 31.16 | 4.56 | 19.1 | 15.55 | 11.19 | 36 | 7224B | 6214-ZZ | 1380 |
| 100HP | 404 TP | 16.5 | 14.75 | 13.5 | 18.1 | 4 | 0.69 | 1 $\frac{1}{2}$ | 2.13 | 0.375 | 0.25-20 | 36.94 | 4.56 | 21 | 16.78 | 13.16 | 42.5 | 7230B | 6217-ZZ | 1430 |
| 125HP | 405 TP | 16.5 | 14.75 | 13.5 | 18.1 | 4 | 0.69 | 1 $\frac{1}{2}$ | 2.13 | 0.375 | 0.25-20 | 36.94 | 4.56 | 21 | 16.78 | 13.16 | 42.5 | 7230B | 6217-ZZ | 1496 |
| 150HP | 444 TP | 16.5 | 14.75 | 13.5 | 21.2 | 4.88 | 0.69 | 1 $\frac{11}{16}$ | 2.5 | 0.375 | 0.25-20 | 42.66 | 5 | 23.3 | 17.78 | 13.53 | 47.7 | 7232B | 6218-ZZ | 1980 |
| 200HP | 445 TP | 16.5 | 14.75 | 13.5 | 21.2 | 4.88 | 0.69 | 1 $\frac{11}{16}$ | 2.5 | 0.375 | 0.25-20 | 42.66 | 5 | 23.3 | 17.78 | 13.53 | 47.7 | 7232B | 6218-ZZ | 2012 |
| 250HP | 445 TP | 16.5 | 14.75 | 13.5 | 21.2 | 4.88 | 0.69 | 1 $\frac{11}{16}$ | 2.5 | 0.375 | 0.25-20 | 42.66 | 5 | 23.3 | 17.78 | 13.53 | 47.7 | 7232B | 6218-ZZ | 2200 |
| 300HP | 5006 P20 | 20 | 14.75 | 13.5 | 31.42 | 9.21 | 13/16 | 1 $\frac{11}{16}$ | 2.5 | 0.375 | 0.25 | 49.78 | 5.66 | 29.1 | 28.58 | 21.54 | 62.48 | 7228B | 6220-ZZ | 2700 |
| 350HP | 5006 P20 | 20 | 14.75 | 13.5 | 31.42 | 9.21 | 13/16 | 1 $\frac{11}{16}$ | 2.5 | 0.375 | 0.25 | 49.78 | 5.66 | 29.1 | 28.58 | 21.54 | 62.48 | 7228B | 6220-ZZ | 2810 |
| 400HP | 5008 P20 | 20 | 14.75 | 13.5 | 31.42 | 9.21 | 13/16 | 1 $\frac{15}{16}$ | 2.5 | 0.50 | 0.25 | 53.91 | 5.66 | 29.1 | 28.58 | 21.54 | 62.48 | 7228B | 6220-ZZ | 2860 |
| 450HP | 5008 P20 | 20 | 14.75 | 13.5 | 31.42 | 9.21 | 13/16 | 2 $\frac{3}{16}$ | 2.5 | 0.50 | 0.25 | 53.91 | 5.66 | 29.1 | 28.58 | 21.54 | 62.48 | 7228B | 6220-ZZ | 3290 |
| 500HP | 5008 P20 | 20 | 14.75 | 13.5 | 31.42 | 9.21 | 13/16 | 2 $\frac{3}{16}$ | 2.5 | 0.50 | 0.25 | 53.91 | 5.66 | 29.1 | 28.58 | 21.54 | 62.48 | 7228B | 6220-ZZ | 3380 |

ALL DATA SUBJECT TO CHANGE WITHOUT NOTICE. USE ONLY CERTIFIED DATA FOR CONSTRUCTION PURPOSES.